

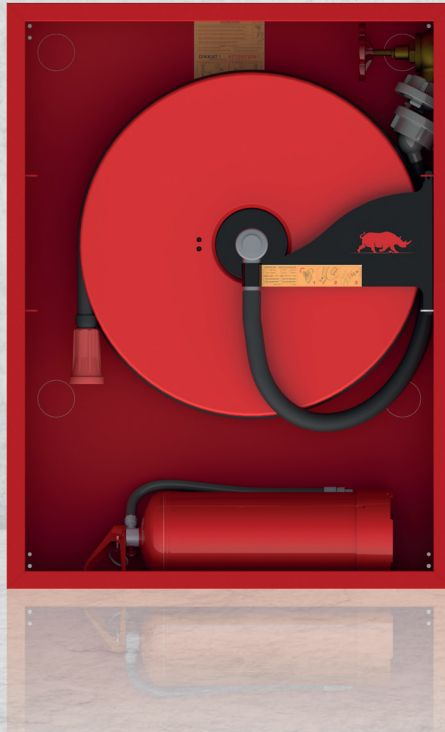

DOORAS
FIRE FIGHTING EQUIPMENT



DRS 1300 SERIES

www.dooras.com

COVER OPTIONS



DRS 1300 T1 COVER



DRS 1300 T2 COVER



DRS 1300 T3 COVER

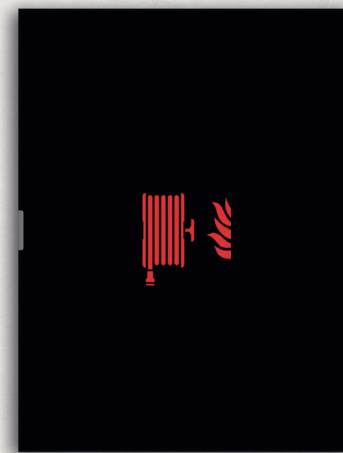

DRS 1300 T4 COVER

DRS 1300

INTERNAL MATERIALS

- Water Supplied from Center, Corrosion Resistant Reel, TS-EN 671-1 / CE Certified
- Semi-Hard Fire Hose with round section, TS EN 694 Certificated
- Interconnection Hose (Unbreakable Type) Providing Water Passage between Valve and Reel Center
- 2" Fire Valve (Brass), TS 12259 Certificated
- 2" Internal Threaded Union (Aluminum - Storz Type) TS 12258 Certificated
- 2"x 1" Reduction (Aluminum - Storz Type) TS 12258 Certificated
- 6mm Made of Sheet Metal, Laser Cut Reel Arm (Provides 270° Reel Movement)
- With Jet, Spray and Off positions and Nozzle according to UL-FM and DIN / EN 671-1
- 6Kg, Dry Chemical Powder Fire Extinguisher Tube (ABC Class) TS862-7 EN3 Certificated
- A1 Quality Sheet Metal Production, Reel Rim
- Reel Rim Phosphate Coating, Completely Electrostatic Powder Painted. (Red)
- Reel Arm Phosphate Coating, Completely Electrostatic Powder Painted. (Black)
- Products are shipped with cardboard packaging after tested hundred percent.
- All Hose Connections are done with Special Press Method. Clamp etc. are never used.
- All hose Connections are covered with plastic to prevent the damage to user.

PRODUCT TECHNICAL SPECIFICATIONS

DISASSEMBLED COVER

- A1 Quality Sheet Metal Production, Disassembled Sheet Metal or Glass Cover
- Recessed Handle (Corrosion Resistant - Stainless)
- 180° Openable, Recessed-Hidden Hinge System (Corrosion Resistant - Stainless)
- 4mm, Smoked Color or Black Painted Tempered Glass on Glass Covers
- Warning Signs and Signs in ISO 7010 Standards on the Cover (Tear-Free and Nonfading)
- Cover Phosphate Coating with Red or White Electrostatic Powder Painted.
- Optional Color and Design Options (Ral Codes for customer requests)
- Optional, Completely Stainless CrNi Material Options are available.

CASE

- A1 Quality Manufactured as a single piece of sheet metal, Recessed or Surface Mounted Case
- Horizontally Positioned 1 piece 6kg Fire Tube Capable Capacity
- Breakable Valve Connection Caps on Side, Top and Back Surfaces of the Case
- Case Design Suitable for Right and Left Handed Reels
- Reinforced Reel / Basket Carrying Console on Both Side Walls of Case
- Mounting, Ventilation and Water Drain Holes
- Case Phosphate Coating with Red or White Electrostatic Powder Painted.
- Optional Color and Design Options (Ral Codes for customer requests)
- Optional, Completely Stainless CrNi Material Options are available.
- Tear-proof, Nonfading, PVC Operating Instructions are available on the Case.

DRS 1300 ONE DOOR FIRE CABINETS WITH SEMI-RIGID HOSE - WITH FIRE EXTINGUISHER HELD HORIZONTAL

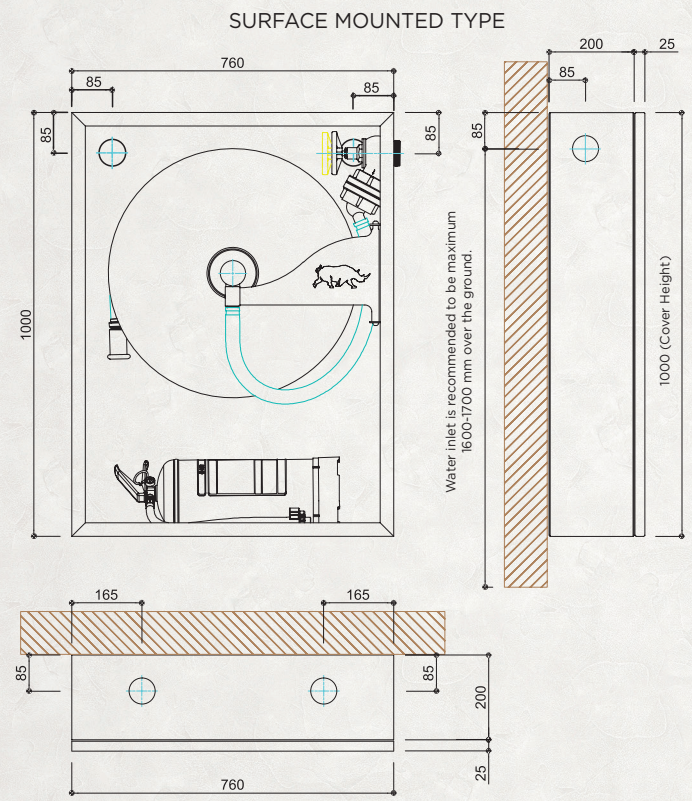
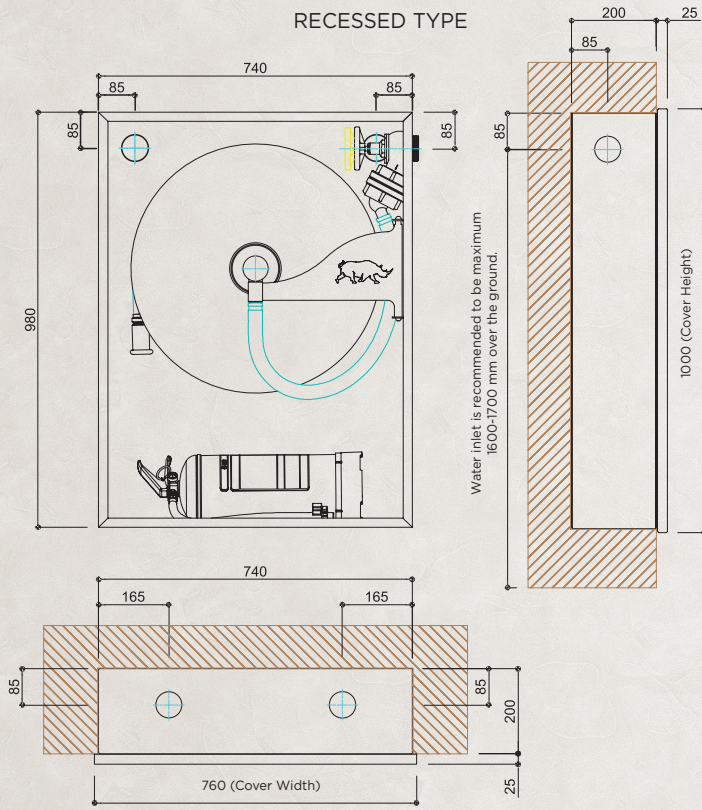

RECESSED TYPE

	MODEL	PRODUCT DESCRIPTION	CASE TYPE	CASE DIMENSIONS (mm)	COVER OPTIONS
1" Semi Hard Hose	DRS1315.1RT_	1"-15m Semi Hard Hosed, Single Cover, Tubed Fire Cabinet	Recessed	740x980x200	T1,T2,T3,T4
	DRS1320.1RT_	1"-20m Semi Hard Hosed, Single Cover, Tubed Fire Cabinet		740x980x200	
	DRS1325.1RT_	1"-25m Semi Hard Hosed, Single Cover, Tubed Fire Cabinet		740x980x200	
	DRS1330.1RT_	1"-30m Semi Hard Hosed, Single Cover, Tubed Fire Cabinet		740x980x200	
3/4" Semi Hard Hose	DRS1315.0RT_	3/4"-15m Semi Hard Hosed, Single Cover, Tubed Fire Cabinet	Recessed	740x980x200	T1,T2,T3,T4
	DRS1320.0RT_	3/4"-20m Semi Hard Hosed, Single Cover, Tubed Fire Cabinet		740x980x200	
	DRS1325.0RT_	3/4"-25m Semi Hard Hosed, Single Cover, Tubed Fire Cabinet		740x980x200	
	DRS1330.0RT_	3/4"-30m Semi Hard Hosed, Single Cover, Tubed Fire Cabinet		740x980x200	

SURFACE MOUNTED TYPE

	MODEL	PRODUCT DESCRIPTION	CASE TYPE	CASE DIMENSIONS (mm)	COVER OPTIONS
1" YSemi Hard Hose	DRS1315.1ST_	1"-15m Semi Hard Hosed, Single Cover, Tubed Fire Cabinet	Surface Mounted	760x1000x200	T1,T2,T3,T4
	DRS1320.1ST_	1"-20m Semi Hard Hosed, Single Cover, Tubed Fire Cabinet		760x1000x200	
	DRS1325.1ST_	1"-25m Semi Hard Hosed, Single Cover, Tubed Fire Cabinet		760x1000x200	
	DRS1330.1ST_	1"-30m Semi Hard Hosed, Single Cover, Tubed Fire Cabinet		760x1000x200	
3/4" Semi Hard Hose	DRS1315.0ST_	3/4"-15m Semi Hard Hosed, Single Cover, Tubed Fire Cabinet	Surface Mounted	760x1000x200	T1,T2,T3,T4
	DRS1320.0ST_	3/4"-20m Semi Hard Hosed, Single Cover, Tubed Fire Cabinet		760x1000x200	
	DRS1325.0ST_	3/4"-25m Semi Hard Hosed, Single Cover, Tubed Fire Cabinet		760x1000x200	
	DRS1330.0ST_	3/4"-30m Semi Hard Hosed, Single Cover, Tubed Fire Cabinet		760x1000x200	

DOORAS A.Ş. reserves the right to make modifications on the products without notification.





DOORAS
FIRE FIGHTING EQUIPMENT

In 3 Different Continents, 15 Different Countries have met

Dooras Quality

Belgium

Turkmenistan

Azerbaijan

Iran

Russia

Kazakhstan

Georgia

Iraq

Libya

Algeria

Senegal

Nigeria

Equatorial Guinea,

Congo

Rwanda

haven't you still met?