

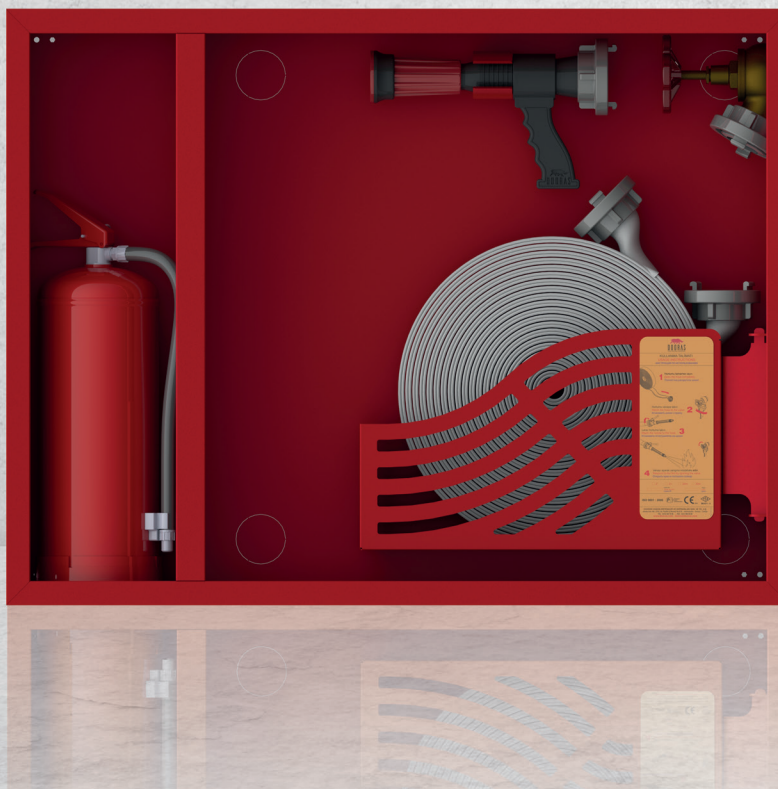

DOORAS
FIRE FIGHTING EQUIPMENT



DRS 2200 SERIES

www.dooras.com

COVER OPTIONS

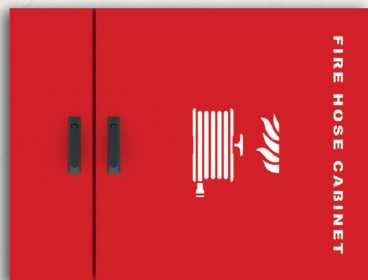

DRS 2200 T1 COVER

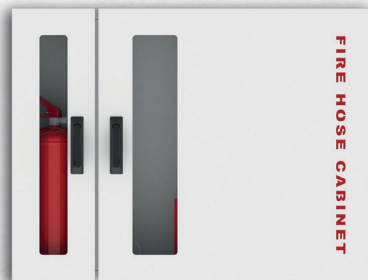

DRS 2200 T2 COVER

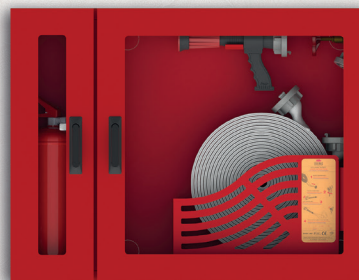

DRS 2200 T3 COVER

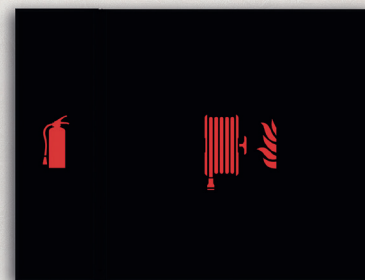

DRS 2200 T4 COVER

NOTE: The product is produced as reel chamber on the right as standard. You can also turn the case and covers 180° to make the reel chamber to be on the left. However, after being turned, the Small Cover and the Large Cover Locks must be replaced with each other.

(Optionally, there is an aluminum controlled lance option. TS 3145 Certificated)



DRS 2200

PRODUCT TECHNICAL SPECIFICATIONS

INTERNAL MATERIALS

- Flat Fire Hose, TS 9222 Certificated
- 2" Fire Valve (Brass), TS 12259 Certificated
- 2" Internal Threaded Union (Aluminum - Storz Type) TS 12258 Certificated
- 2" Hose Union (Aluminum - Storz Type), TS 12258 Certificated
- Movable hose basket with 90° angle of motion
- "Swivel Head Controlled Lance" with Jet, Spray and Off positions (EN 671-2 compliant)
- 6Kg, Dry Chemical Powder Fire Extinguisher Tube (ABC Class) TS862-7 EN3 Certificated
- Hose Basket Phosphate Coating, Completely Electrostatic Powder Painted.
- Products are shipped with cardboard packaging after tested hundred percent.
- Optionally, there is an aluminum controlled lance option. TS 3145 Certificated
- All Hose Connections are done with Special Press Method. Clamp etc. is never used.
- All hose connections are covered with plastic to prevent the damage to user.
- 2.5" Option is offered in all products.

DISASSEMBLED COVER

- A1 Quality Sheet Metal Production, Disassembled Sheet Metal or Glass Cover
- Recessed Handle Lock on T1 - T2 - T3 Model Covers (Corrosion Resistant - Stainless)
- "End to End Cover Handle" on T4 Model Covers
- 180° Openable, Recessed-Hidden Hinge System (Corrosion Resistant - Stainless)
- 4mm, Smoked Color or Black Painted Tempered Glass on Glass Covers
- Warning Signs and Signs in ISO 7010 Standards on the Cover (Tear-Free and Nonfading)
- Cover Phosphate Coating with Red or White Electrostatic Powder Painted.
- Optional Color and Design Options (Ral Codes for customer requests)
- Optional, Completely Stainless CrNi Material Options are available.

CASE

- A1 Quality Manufactured as a single piece of sheet metal, Recessed or Surface Mounted Case
- Vertically Positioned 1 piece 6kg Fire Tube Capable Capacity
- Breakable Valve Connection Caps on Side, Top and Back Surfaces of the Case
- Case Design Suitable for Right and Left Handed Reels
- Can be used right or left by turning the case 180°.
- Mounting, Ventilation and Water Drain Holes
- Case Phosphate Coating with Red or White Electrostatic Powder Painted.
- Optional Color and Design Options (Ral Codes for customer requests)
- Optional, Completely Stainless CrNi Material Options are available.
- Tear-proof, Nonfading, PVC Operating Instructions are available on the Case.

DRS 2200 DOUBLE DOOR FIRE CABINETS WITH LAY FLAT HOSE - WITH FIRE EXTINGUISHER HELD UPRIGHT

RECESSED TYPE

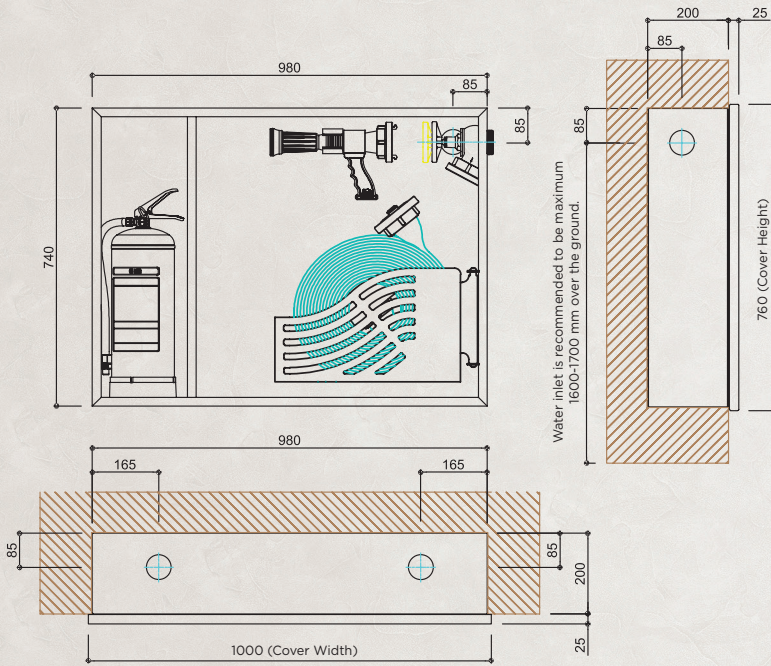

SURFACE MOUNTED TYPE

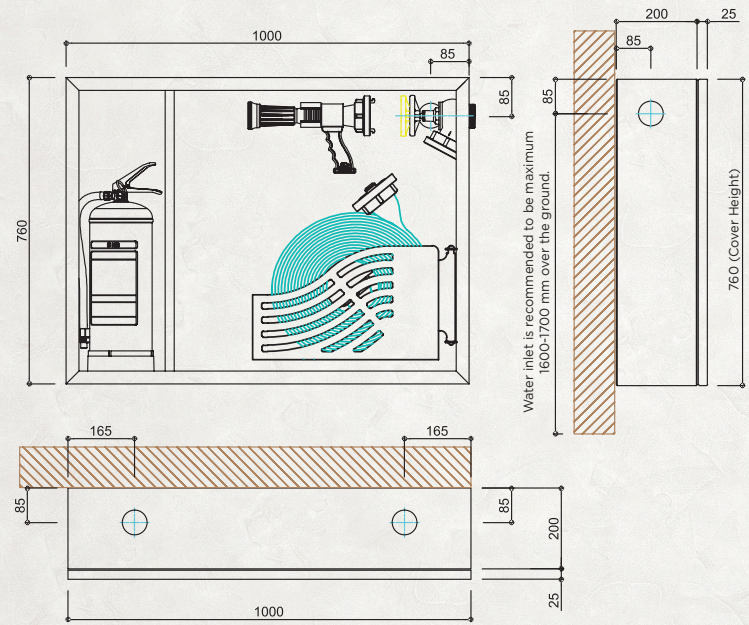

RECESSED TYPE

	MODEL	PRODUCT DESCRIPTION	CASE TYPE	CASE DIMENSIONS (mm)	COVER OPTIONS
2" Flat Hose	DRS2220.2RT_	2"-20m Semi Hard Hosed, Double Cover, Tubed Fire Cabinet	Recessed	980x740x200	T1,T2,T3,T4
	DRS2230.2RT_	2"-30m Semi Hard Hosed, Double Cover, Tubed Fire Cabinet		980x740x200	
2 1/2" Flat Hose	DRS2220.3RT_	2 1/2"-20m Semi Hard Hosed, Double Cover, Tubed Fire Cabinet	Recessed	980x740x220	T1,T2,T3,T4
	DRS2230.3RT_	2 1/2"-30m Semi Hard Hosed, Double Cover, Tubed Fire Cabinet		980x740x220	

SURFACE MOUNTED TYPE

	MODEL	PRODUCT DESCRIPTION	CASE TYPE	CASE DIMENSIONS (mm)	COVER OPTIONS
2" Flat Hose	DRS2220.2ST_	2"-20m Semi Hard Hosed, Double Cover, Tubed Fire Cabinet	Surface Mounted	1000x760x200	T1,T2,T3,T4
	DRS2230.2ST_	2"-30m Semi Hard Hosed, Double Cover, Tubed Fire Cabinet		1000x760x200	
2 1/2" Flat Hose	DRS2220.3ST_	2 1/2"-20m Semi Hard Hosed, Double Cover, Tubed Fire Cabinet	Surface Mounted	1000x760x220	T1,T2,T3,T4
	DRS2230.3ST_	2 1/2"-30m Semi Hard Hosed, Double Cover, Tubed Fire Cabinet		1000x760x220	



DOORAS A.Ş. reserves the right to make modifications on the products without notification.



DOORAS
FIRE FIGHTING EQUIPMENT

He lost his wife and two
children in the fire.



www.dooras.com