



**DOORAS**  
FIRE FIGHTING EQUIPMENT



# DRS 2300 SERIES

[www.dooras.com](http://www.dooras.com)

# COVER OPTIONS



DRS 2300 T1 COVER



DRS 2300 T2 COVER



DRS 2300 T3 COVER

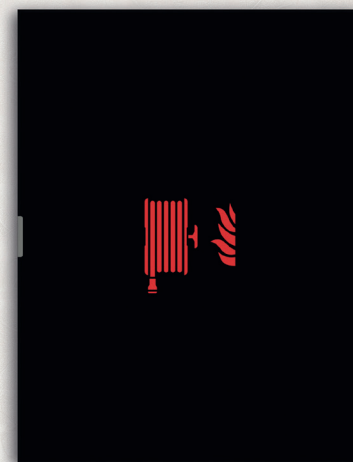

DRS 2300 T4 COVER

(Optionally, there is an aluminum controlled lance option. TS 3145 Certified)



## DRS 2300

## PRODUCT TECHNICAL SPECIFICATIONS

### INTERNAL MATERIALS

- Flat Fire Hose, TS 9222 Certified
- 2" Fire Valve (Brass), TS 12259 Certified
- 2" Internal Threaded Union (Aluminum - Storz Type) TS 12258 Certified
- 2" Hose Union (Aluminum - Storz Type), TS 12258 Certified
- Movable hose basket with 90° angle of motion
- "Swivel Head Controlled Lance" with Jet, Spray and Off positions (EN 671-2 compliant)
- 6Kg, Dry Chemical Powder Fire Extinguisher Tube (ABC Class) TS862-7 EN3 Certified
- Hose Basket Phosphate Coating, Completely Electrostatic Powder Painted.
- Products are shipped with cardboard packaging after tested hundred percent.
- Optionally, there is an aluminum controlled lance option. TS 3145 Certified
- All Hose Connections are done with Special Press Method. Clamp etc. is never used.
- All hose connections are covered with plastic to prevent the damage to user.
- 2.5" Option is offered in all products.

### DISASSEMBLED COVER

- A1 Quality Sheet Metal Production, Disassembled Sheet Metal or Glass Cover
- Recessed Handle (Corrosion Resistant - Stainless)
- 180° Openable, Recessed-Hidden Hinge System (Corrosion Resistant - Stainless)
- 4mm, Smoked Color or Black Painted Tempered Glass on Glass Covers
- Warning Signs and Signs in ISO 7010 Standards on the Cover (Tear-Free and Nonfading)
- Cover Phosphate Coating with Red or White Electrostatic Powder Painted.
- Optional Color and Design Options (Ral Codes for customer requests)
- Optional, Completely Stainless CrNi Material Options are available.

### CASE

- A1 Quality Manufactured as a single piece of sheet metal, Recessed or Surface Mounted Case
- Horizontally Positioned 1 piece 6kg Fire Tube Capable Capacity
- Breakable Valve Connection Caps on Side, Top and Back Surfaces of the Case
- Case Design Suitable for Right and Left Handed Reels
- Reinforced Reel / Basket Carrying Console on Both Side Walls of Case
- Mounting, Ventilation and Water Drain Holes
- Case Phosphate Coating with Red or White Electrostatic Powder Painted.
- Optional Color and Design Options (Ral Codes for customer requests)
- Optional, Completely Stainless CrNi Material Options are available.
- Tear-proof, Nonfading, PVC Operating Instructions are available on the Case.

# DRS 2300 ONE DOOR FIRE CABINETS WITH LAY FLAT HOSE - WITH FIRE EXTINGUISHER HELD HORIZONTAL

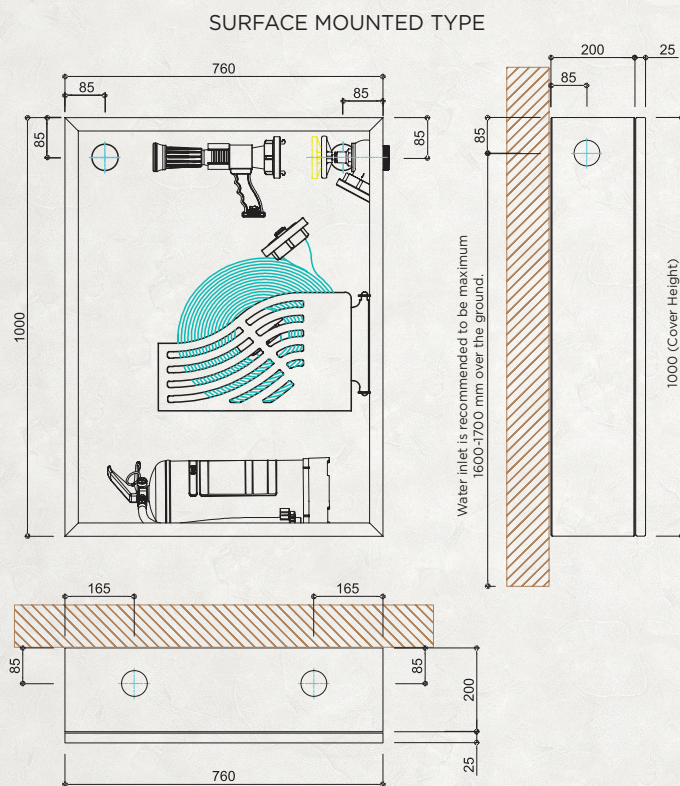
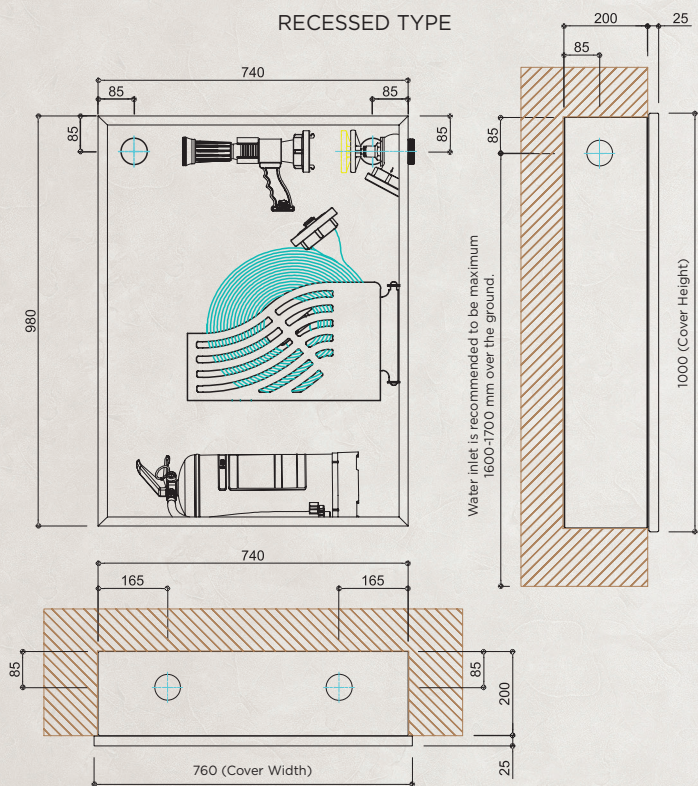

RECESSED TYPE

	MODEL	PRODUCT DESCRIPTION	CASE TYPE	CASE DIMENSIONS (mm)	COVER OPTIONS
2" Flat Hose	DRS2320.2RT_	2"-20m Flat Hosed, Single Cover, Tubed Fire Cabinet	Recessed	740x980x200	T1,T2,T3,T4
	DRS2330.2RT_	2"-30m Flat Hosed, Single Cover, Tubed Fire Cabinet		740x980x200	
2 1/2" Flat Hose	DRS2320.3RT_	2 1/2"-20m Flat Hosed, Single Cover, Tubed Fire Cabinet	Recessed	740x980x220	T1,T2,T3,T4
	DRS2330.3RT_	2 1/2"-30m Flat Hosed, Single Cover, Tubed Fire Cabinet		740x980x220	

SURFACE MOUNTED TYPE

	MODEL	PRODUCT DESCRIPTION	CASE TYPE	CASE DIMENSIONS (mm)	COVER OPTIONS
2" Flat Hose	DRS2320.2ST_	2"-20m Flat Hosed, Single Cover, Tubed Fire Cabinet	Surface Mounted	760x1000x200	T1,T2,T3,T4
	DRS2330.2ST_	2"-30m Flat Hosed, Single Cover, Tubed Fire Cabinet		760x1000x200	
2 1/2" Flat Hose	DRS2320.3ST_	2 1/2"-20m Flat Hosed, Single Cover, Tubed Fire Cabinet	Surface Mounted	760x1000x220	T1,T2,T3,T4
	DRS2330.3ST_	2 1/2"-30m Flat Hosed, Single Cover, Tubed Fire Cabinet		760x1000x220	

DOORAS A.Ş. reserves the right to make modifications on the products without notification.





**DOORAS**  
FIRE FIGHTING EQUIPMENT

